

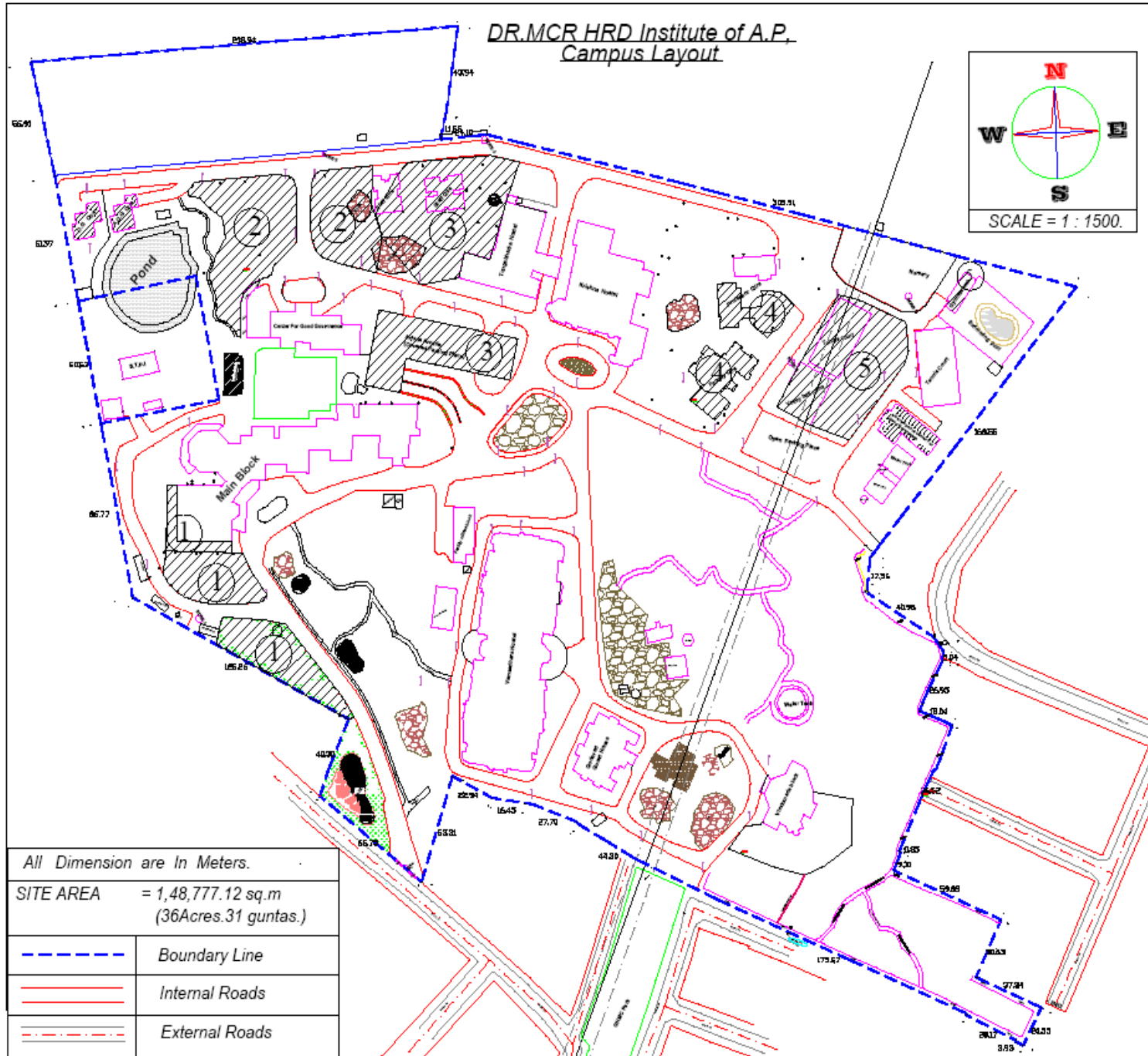

# DR MCR HRD Institute

## GOVERNMENT OF TELANGANA

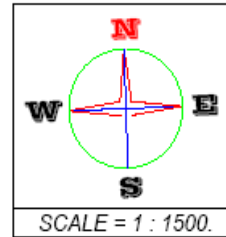

# DR.MCR HRD Institute of A.P. Campus Layout

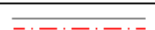

All Dimension are In Meters.	
SITE AREA = 1,48,777.12 sq.m (36Acres.31 guntas.)	
	Boundary Line
	Internal Roads
	External Roads





# Campus Map

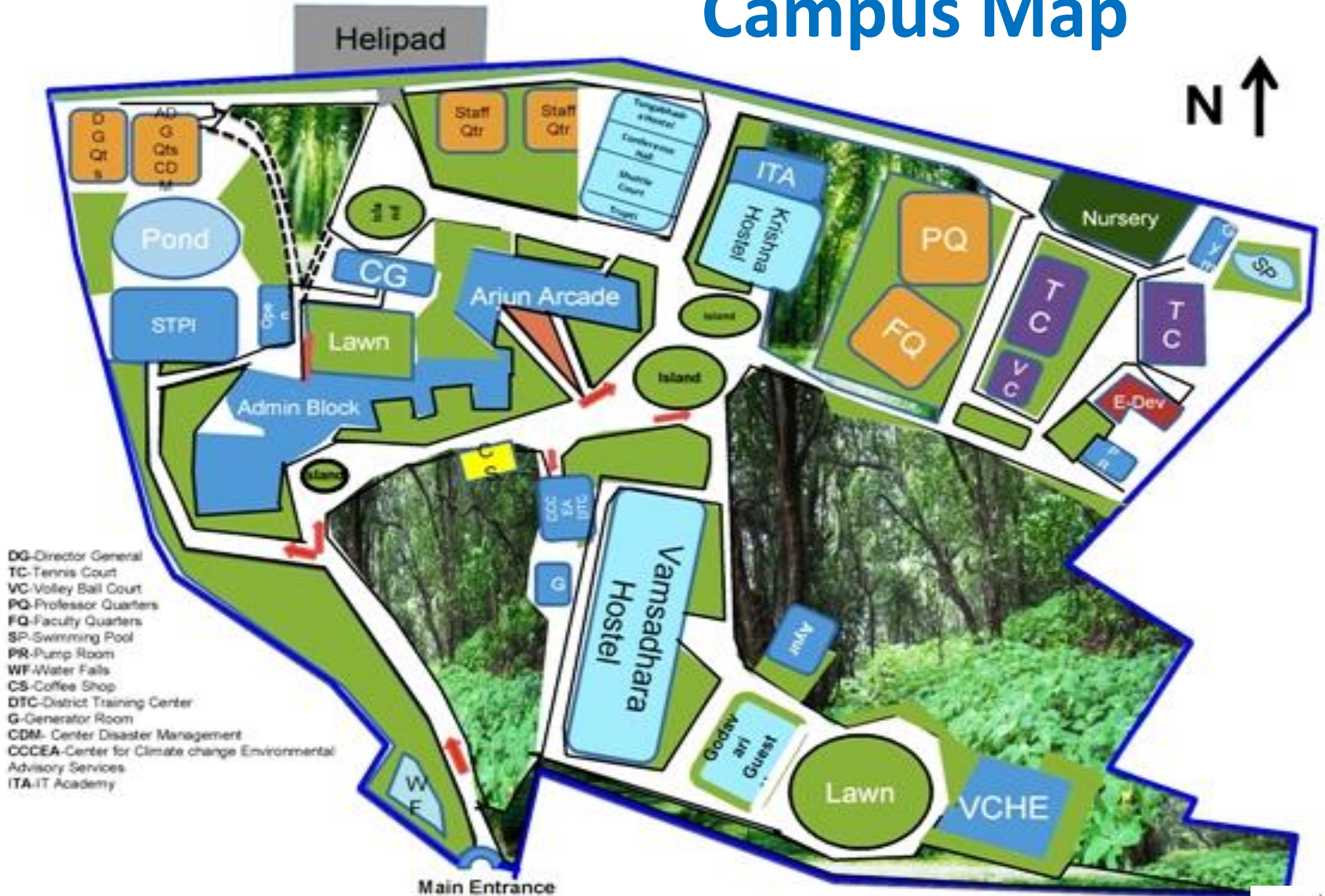

The total area of the Campus is 35 Acers



# Admin Block





## Lecture halls



15 lecture halls with LCD Projectors, Computer, Audio System, Air Conditioned and Well Furnished.



## Computer Labs



1. Three computer labs each with 30 desktops on LAN.
2. 250 computers located in the Institute.



## Conference Halls



### **5 conference halls**

Two in Admin block with capacity of 20 & 100

Third at Thungabhadra Hostel 3<sup>rd</sup> floor with 150 capacity.

Fourth & fifth at Vamsadhara Residency 2<sup>nd</sup> & 4<sup>th</sup> floors with capacity of 20 & 40



## Auditorium



Capacity 250, Air-conditioned, Well Furnished, Push-back Seats, Integrated Audio and Video Facilities.





## Lawns



### **Three major lawns :**

First before open air auditorium, i.e Admin Block

Second before Godavari Guest House

Third beside Vivekananda Yoga Center.



# Library



1. Location: Cellar of Admin Block
2. 10,000 books
3. Computer Science, Journalism, Library, Science, Philosophy, Psychology, Sociology, Economics, Public Administration, Training methods/codes/manuals
4. Timing: 8:30 am to 10:00 pm
5. Participants can barrow books





## Video Conference Hall



Video Conference facility to all district head quarters & secretariat.





## THREE MAJOR HOSTELS

**Vamsadhara  
Residency  
Tungabhadra Hostel  
Krishna Hostel**



# Vamsadhara Residency



1. 130 Executive double bedded rooms.
2. 240 Other rooms
3. Centralized Air Conditioned
3. 20 computers with net facility on 1<sup>ST</sup> & 2<sup>nd</sup> floor
4. Reading room with news papers & magazines on 1<sup>st</sup> floor
5. Wi – Fi Facility
6. Dining with capacity of 163 in ground floor
7. Hot water



## Tunghabadhra Hostel



1. 28 double bedded rooms
2. Wi – Fi Facility
3. Pushti dining hall capacity of 150 in first floor
4. Trupti canteen with dining facility with capacity of 200
5. Hot water facility





## Krishna Hostel



1. 34 double bedded rooms and 8 four bedded rooms.
2. One dormitory with 15 beds capacity.
3. Lobby with seating.
4. Hot water facility.



## Godavari Guest House



1. 17 AC VVIP Suite for Secretary and above cadre officers
2. Computer with internet facility
3. Lobby with daily news papers and weekly magazines
4. Wi – Fi Facility
5. Dining facility with capacity of 40 at 2<sup>nd</sup> Floor
6. 24/7 Hot water facility



# Vivekananda Centre



1. Art of living on ground floor with instructors for 80 people capacity  
Time: 6 Am to 8 Am

2. Yoga hall on 1<sup>st</sup> floor with Yoga mats and Yoga teacher for 100 people capacity  
Yoga Time: 7Am to 8 Am

3. Music room in ground floor.

***MENS SANA IN CORPORE SANO***  
**(Sound mind in sound body)**





## Sports



**Tennis court**

2 Tennis courts

Timing: (6:00 AM to 8:00 AM open to all)  
(5:00 PM to 8:30 PM open to all)



**Badminton court**

One Indoor Wooden Badminton court at Tungabhadra  
2<sup>nd</sup> floor,

Timing: (6:00 AM to 9:00 AM for Ladies)  
(5:00 PM to 9:00 PM for Gents)





Volley ball court.

Timing : (6:00 AM to 8:00 AM open to all)  
(5:00 PM to 8:30 PM open to all)

**Volley ball court**



Billiards board at Vamsadhara Residency on 3<sup>rd</sup> Floor

Timing : (6:00 AM to 8:00 AM open to all)  
(5:00 PM to 8:30 PM open to all)





**Table Tennis**

2 Table tennis boards at Vamsadhara Residency on 3<sup>rd</sup> Floor

Timing : (6:00 Am to 8:00 Am open to all)  
(5:00 Pm to 8:30 Pm open to all)



**GYM**

Well equipped Gym with Instructor

Timing:  
(6:00 AM to 8:00 AM open to all)  
(5:00 PM to 7:00 PM for Gents)  
(7:00 PM to 8:30 PM for Ladies)







**Swimming Pool**

One well maintained Swimming pool with a Swimming instructor and a lifeguard

Timing :

(6:00 AM to 8:00 AM open to all)

(5:00 PM to 7:00 PM for Gents)

(7:00 PM to 8:30 PM for Ladies)



**Cricket Kit**

Cricket kit is available.





**Chess**

Caroms and Chess boards at Vamsadhara Reception



**Caroms**



# CANTEEN & DINING



Timing :

Breakfast from 8:15 am to 9:30am

Lunch from 1:15 pm to 2:30pm

Dinner from 8:15 pm to 9:30pm

1. Bed tea at 6:00 am
2. Food not allowed in the rooms
3. Complaint on food registered in the dining hall





## CANTEEN & DINING

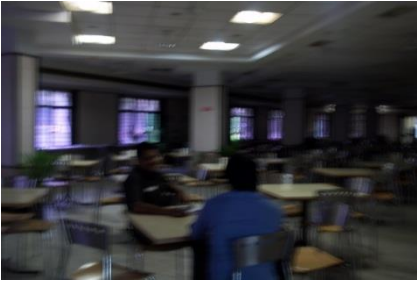

**Thrupthi canteen**

Thungabhadra :  
Thrupthi canteen with 200 seating capacity  
Pushthi canteen with 124 seating capacity



**Vamsadhara Dining Hall**

Vamsadhara : Dining Hall with 163 seating capacity



**Admin Cafeteria**

Cafeteria at Admin block with 100 capacity.

Executive Lounge at Admin block with 50 capacity



## MEDICAL DISPENSARY



Right opposite to the Vamsadhara Residency.

Doctor timing: 5:30 pm to 6:30 pm.

Doctor will available in Room No 266 second floor

In case of emergency candidates taken to near by hospital.

Emergency: Vehicle available



# Quarters



**Professor Quarters**



**Faculty Quarters**



**Staff Quarters**





# HELIPAD



Helipad near DG & ADG quarters



# Transport



Swaraj Mazda mini bus: capacity of 20 seats



Two golf carts : Each with capacity 11 for Physically challenged participants.



One shuttle service tempo available for pick and drop from Dr. MCR HRDI to Jubilee Hills Check Post and back



## Vehicle Parking



**Arjuna Arcade**

Three storied building parking at Arjuna Arcade, capacity of 200 four wheelers



Two wheeler parking behind Admin block





## Laundry



Two Front loaded Washing Machines & Electrical Cloth Dryers at Vamsadhara Residency in Room No C-22.



Two top loaded washing machines at Thungabhadra Hostel.



Laundry collection & delivery on payment basis and laundry persons will be available at Vamsadhara residency near reception from 8:00 AM to 10:00 AM



# BARBER SHOP



Krishna Hostel, Room No.106

Timings :- 07:00am to 09:00am (Morning)  
05:30pm to 09:00pm (Evening)





# Dr MCRHRDI An Eco Responsible Institute

- Set an example
- Promote optimum resource use
- Demonstrative effect
- Cut ecological impact

**Reduce Reuse and Recycle  
Principle**





## Ancient Indian Story of Recycling

Once upon a time in ancient India, a Queen after listening to the Buddha's wonderful teachings entire day gave a big bag of gold to Ananda, Buddha's disciple. He was asked, "What are you going to do with so much money?" Ananda replied, "I will go to the market and buy all the cloth that we can carry."

"But what'll you do with all the cloth?"

"We'll give them to the monks dressed in rags."

"But what'll you do with their old clothes?" "We'll make them into new quilts."

"But what'll you do with the old quilts?" "We'll make them into new pillows."

"But what'll you do with the old pillows?" "We'll make them into new rugs."

"But what'll you do with the old rugs?" "We'll make them into new doormats."

"But what'll you do with the old doormats?" "We'll make them into new brooms."

"But what'll you do with the old brooms?"

"Well, Your Highness, we will take them apart and use them for plastering the walls of our houses - to strengthen them" he said.

**Let us try to recycle all the material that we use.**



# Our Green Outdoors



# Eco Responsible Institute: Process

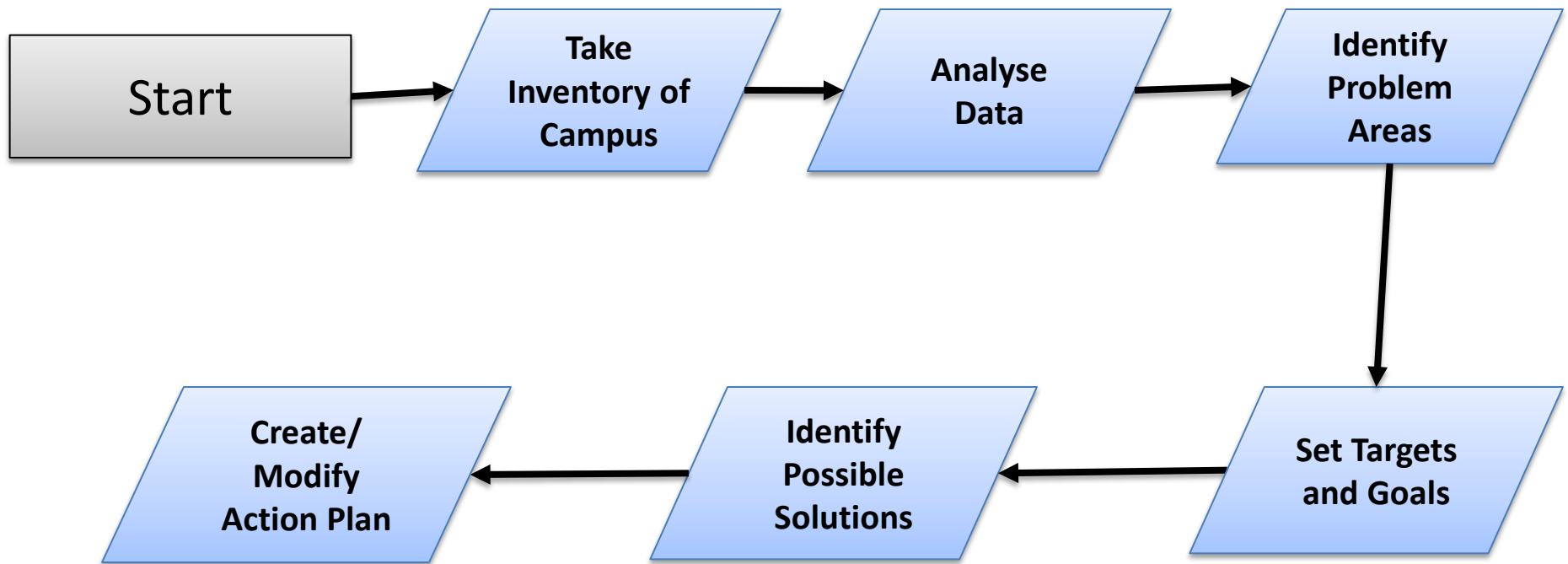



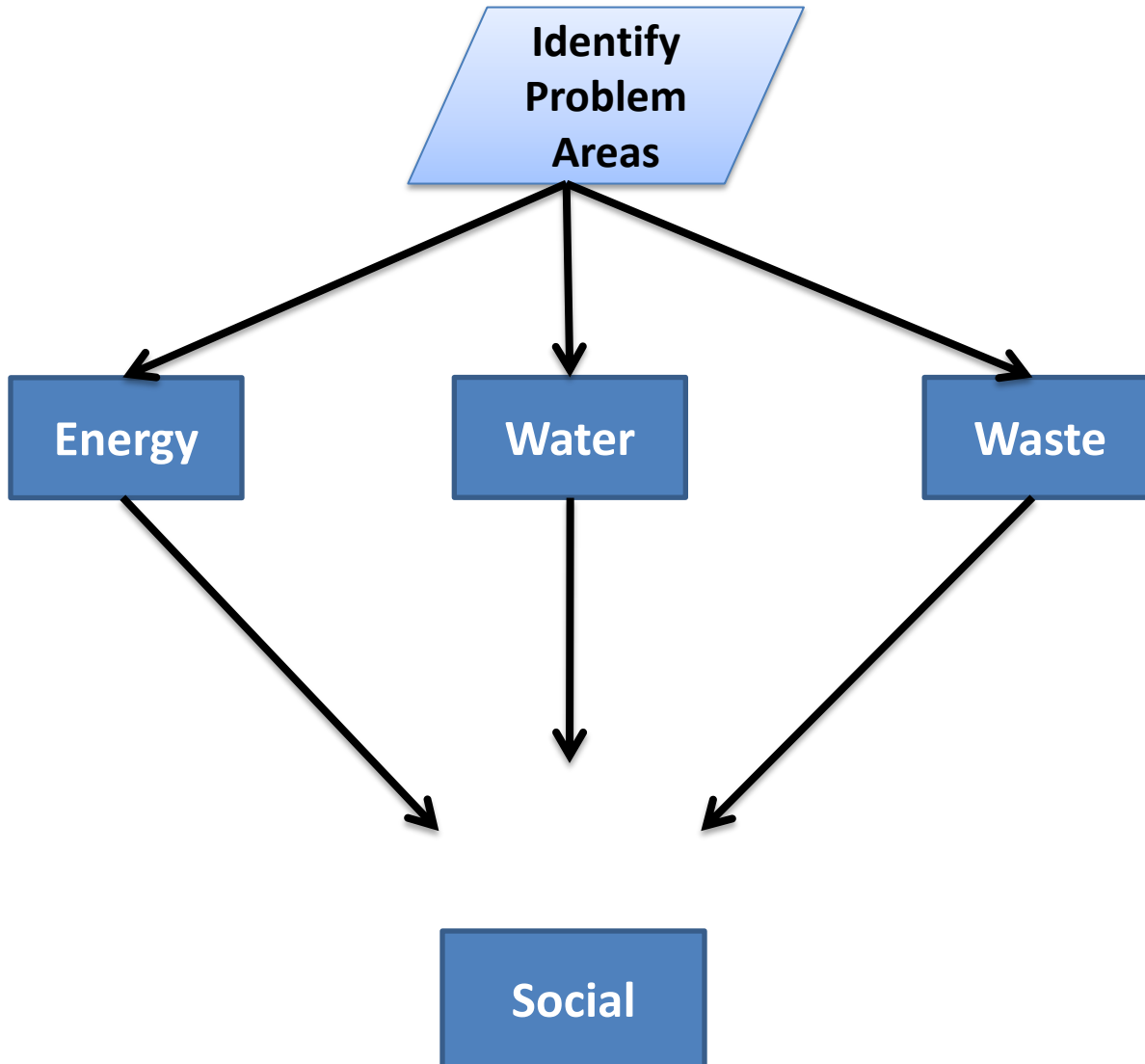

## Rainwater Catchment Areas plus IBW RWH method for abandoned & partially dry Bore wells

Sl. No	Name of the Block	Area(in sq. Mtrs)	Surface/ landscape and rooftop area	Taken rainwater percolation 50% for landscape & 99% for rooftop area	Volume of Rain water @ 70 cms p/a in lakhs litres
<b>1</b>	<b>Bore-1 Near Parking</b>				
a	Admin Block Opposite area	1073.00	Surface/ landsacpe area	536.5 sqmtrs	3.8 lakh
b	Pond side area from entrance left side	1314.559	Surface/ landsacpe area	657.2795 sqmtrs	4.65 lakhs
c	Administrative Building L-shape area	268.92	Rooftop area	135 sqmtrs	1 lakh
	Total	2656.48		1328 sqmtrs	9.3 lakhs
<b>2</b>	<b>Bore-2 Near Helipad Gate</b>				
a	Left side area Opposite to CGG Building	2325.59	Surface/ landscape area	1163 sqmtrs	8.15 lakhs
b	Right side area Opposite to CGG Building	1507.599	Surface/ landscape area	754 sqmtrs	5.3 lakhs
	Total			1917 sqmtrs	13.45 lakhs
<b>3</b>	<b>Bore-3 Near CRPF Compound Wall</b>				
a	Arjuna arcade	1500	Rooftop area	750 sqmtrs	5.3 lakhs
b	Btw staff Quarters and Tungabhadra hostel including both Staff Quarters	3150.72	Surface/ landscape area	1575 sqmtrs	11 lakhs
	Total	4650.72		2325.358 sqmtrs	16.3 lakhs
<b>4</b>	<b>Bore-4 opposite to Faculty &amp; Professor Quarters</b>				
a	Faculty Quarters	648.74	Rooftop area	648.74 sqmtrs	4.5 lakhs
b	Professor Quarters	808.13	Rooftop area	808.13 sqmtrs	5.7 lakhs
	Total	3833.18		1456.87	10.2 lakhs
<b>5</b>	<b>Bore-5 Near Nursery</b>				
a	Tennis, Volley ball Court and Side open area	2782.76	Surface/ landsacpe area	1391 sqmtrs	9.75 lakhs
b	Gym & sports Building near area	127	Rooftop area	127 sqmtrs	0.9 lakhs
	Total	2909.76		1454.882 sqmtrs	10.2 lakhs
	<b>Grand Total</b>	59.45 lakh litres per annum			



# Drinking Water Consumption



- 100 bubble tops x 20 liters = 2000 liters capacity bubble tops
- Bill Rs 40 to 50 thousands per month.
- **100 x 23 x 30 = Rs 69000 peak**
- **Proposing an RO plant of 500 liters per hour**
- Capital cost = Machinery Rs 4 lakhs + New cans Rs 30,000(Rs 150 x 200 cans)
- Operational = Rs 5000(power) + 9000(manpower)



# Solid Waste Generation



- Wet waste: 100 - 500 Kgs of Kitchen / food waste for composting
- 500 gms per capita per day





# Solar Power

SIMPLIFIED SKETCH OF NETMETERING

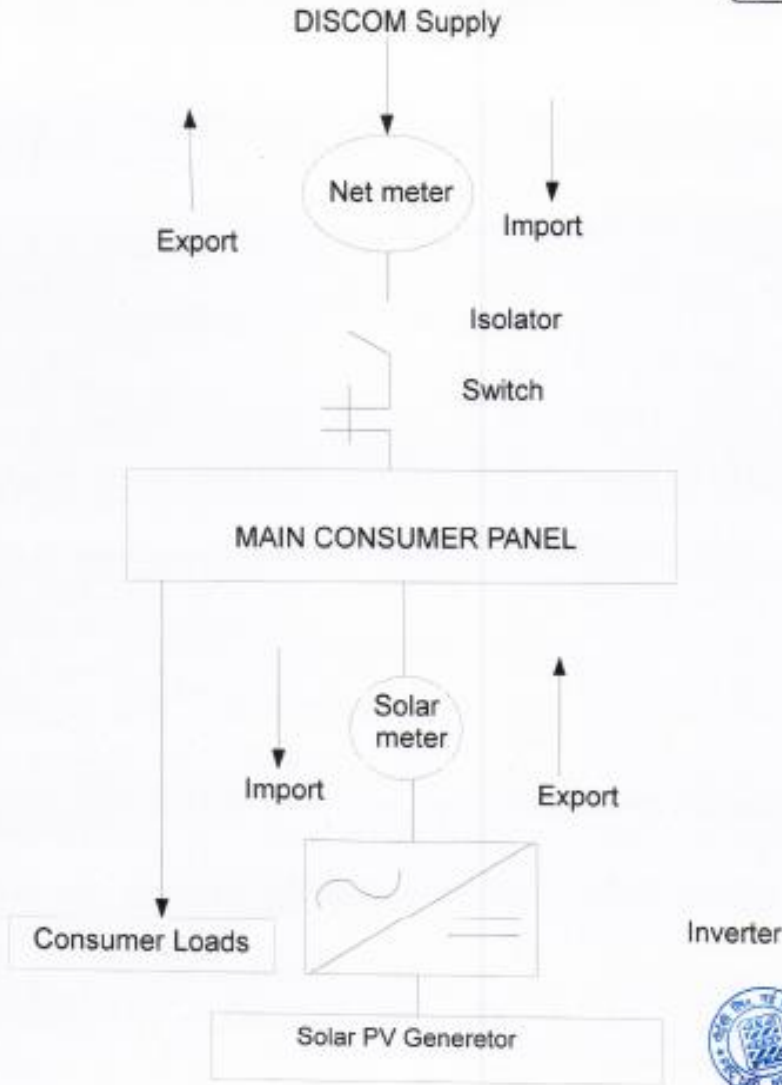

- Solar street lamps planned
- Solar initiative is Grid Connection based
- 490 kw capacity
- 8 locations on the campus
- Rs 3.87 crores(- 30% subsidy)



# Waste Water Treatment

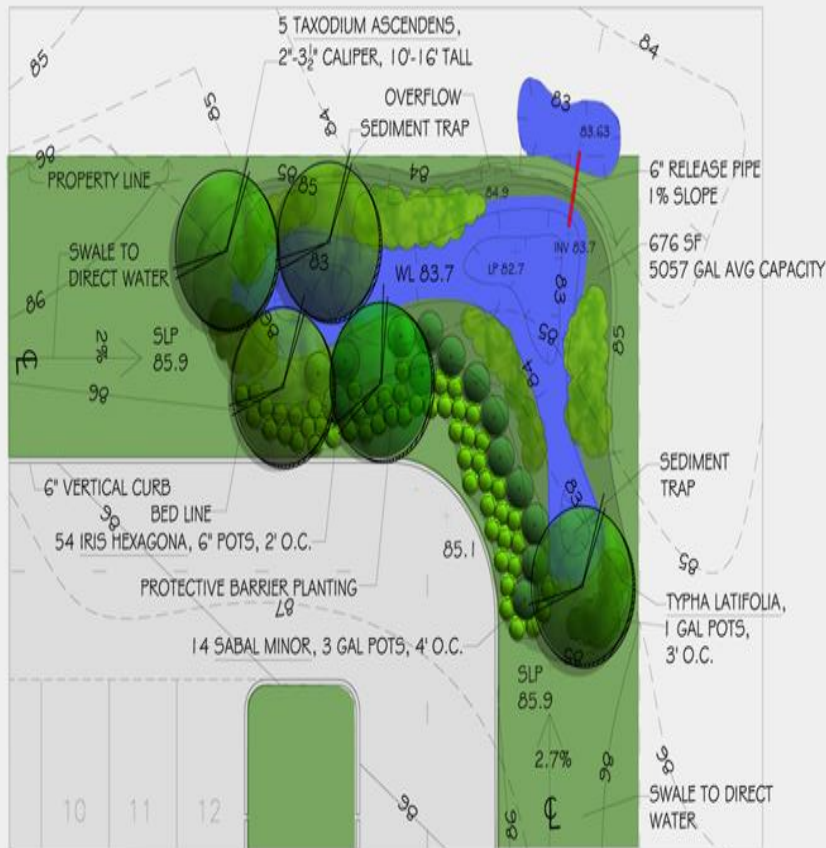

CONSTRUCTED WETLAND

CMS659572

- Installation of treatment ponds.
- Installation of suitable, local gravel of different dimensions
- Installation of suitable hydrology techniques including pumps, piping and fixtures.
- Plantation of suitable plant species which can treat the waste water that is generated.
- Integration/ inoculation of Microbes.



# Towards an Eco Responsible Institute

- ❖ Roof Top Solar Water Heating Introduced
- ❖ Pole Top Solar Street Lighting being Introduced
- ❖ Roof Top Grid Connected 500 KV Solar PV Power Generation to be Introduced

- ❖ Food Waste Composted
- ❖ Garden Waste Composted
- ❖ Used Water Treatment and Reuse for Gardening being Introduced

- ❖ Rain Water Diversion for Plantation Introduced
- ❖ Storage of excess Rain Water Introduced
- ❖ Recharge of excess Rain Water being Introduced

**Action Point 5**  
Go Solar

**Action Point 4**  
Reuse and Recycle the Waste

**Action Point 3**  
Reuse

**Action Point 2**  
Optimise Usage of Resources

**Action Point 1**  
Reduce Waste

- ❖ Water: Meters for Measuring, Monitoring and Managing Water Consumption Introduced
- ❖ Power: Meters for Measuring, Monitoring and Managing Energy Consumption Introduced
- ❖ Low Mast LED lights in place of High Mast Halogen Lights being Introduced
- ❖ Energy Audit based reduction of Air Conditioning Introduced

- ❖ Water: Meters for Measuring, Monitoring and Managing Water Consumption Introduced
- ❖ Power: Meters for Measuring, Monitoring and Managing Energy Consumption Introduced
- ❖ Low Mast LED lights in place of High Mast Halogen Lights being Introduced
- ❖ Energy Audit based reduction of Air Conditioning Introduced





# Rain Water Harvesting



Site based Inverse Borewell for Rainwater Harvesting replenishing deep aquifers

Capturing huge run off as a solution for saving power and avoiding distant pumping





# Water Harvesting

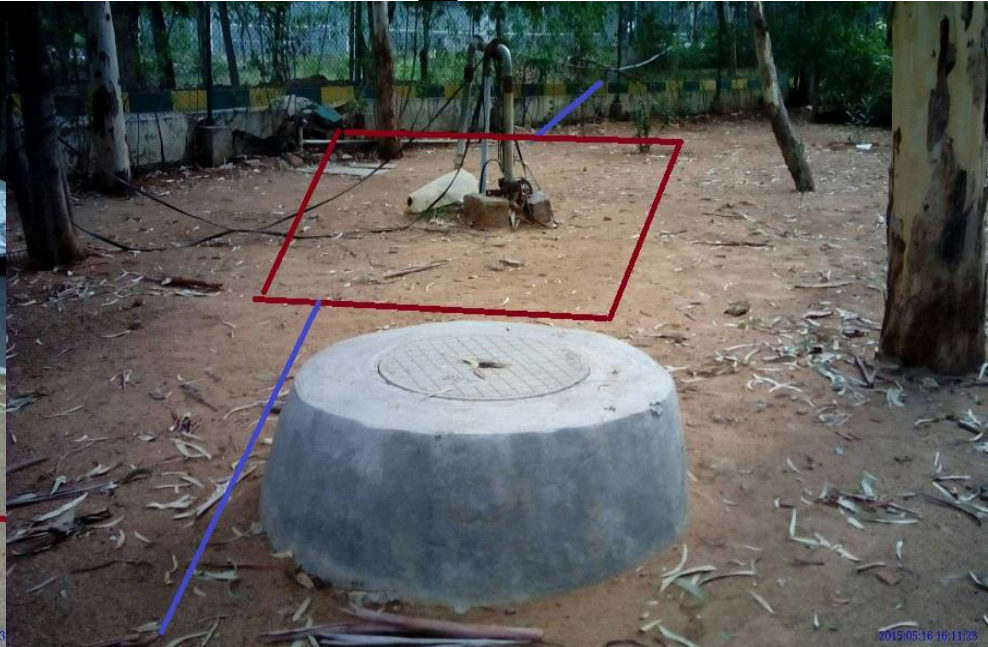



# Source Segregation



- **WET WASTE (ORGANIC WASTE)**
- **Bin 1**
- Food Waste (Cooked food)
- Kitchen Waste (All waste vegetable, fruits, wet waste)
- Coconut waste
- Garden Waste.
  
- **DRY WASTE (INORGANIC WASTE)**
- **Bin 2**
- Paper
- Plastic
- Metal
- Glass.



# Solid Waste Management



- Wet waste: 100 - 500 Kgs of Kitchen / food waste for composting
- 500 gms per capita per day





# Reduced Water Use



- Water Metering, Push Type Taps, Timers, Male Urinals, Leakage Surveys for arresting leakages
- Two level/two button water use flush tanks





# Reduced Water Use



- Changing of bed linen and towels once in 5 days or as requested.
- Scheduled watering of plants and garden/lawns



# Reduced Waste Generation



Restricted supply of Non-vegetarian food which has high ecological footprint



# Reduced use of Disposables



Disposable water glasses, tea/coffee cups and water bottles is banned on the campus



# Paper and Printing



- Printers which print both sides of a page in one go
- Use of one side printed paper for drafts, internal circulars

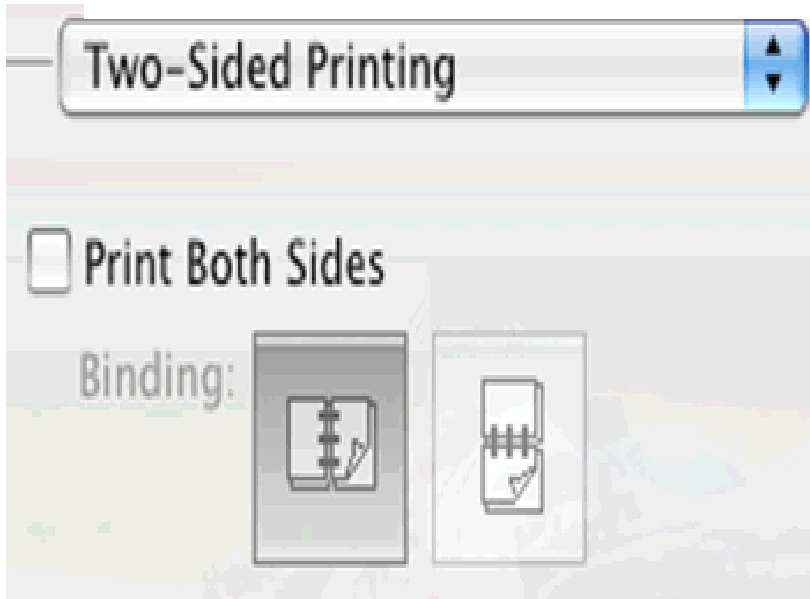



# Reduced Electricity Consumption

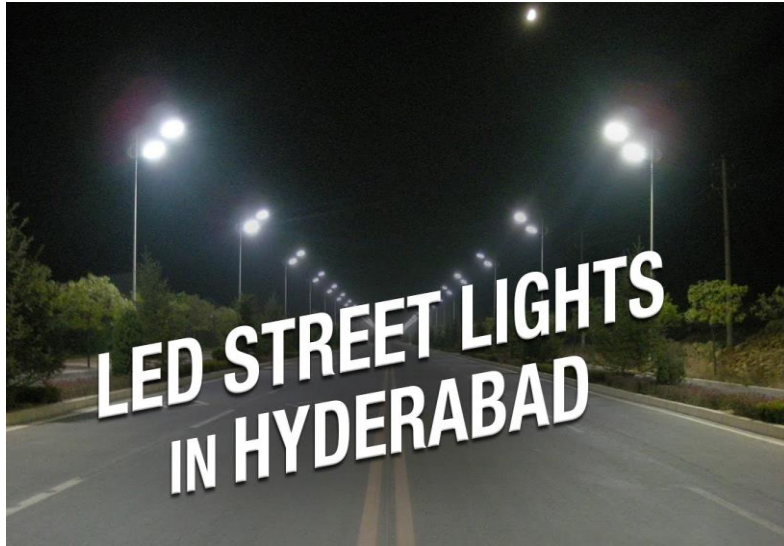

- Metering and Cost Centre Approach focusing high energy consuming units/blocks and consumption monitoring



- Completed Campus Energy Audit



# Reduced Electricity Consumption



- ACs Temperature being fixed at 22C or 23C
- Replacing old high energy consuming fans
- Replacing CFL lamps with LED on completion of their life period
- Air filters of all ACs cleaned every 3 months



# Reuse of Containers



- Reusable steel water tumblers/glasses near water dispenser
- Refillable water bottles for meetings and conferences



# How much water we can **save**

## Use Bucket.. Conserve Water...

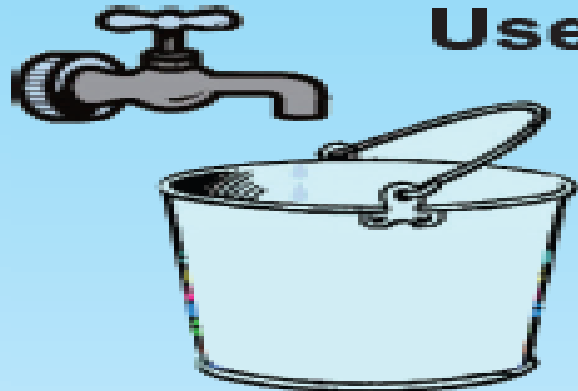

Water usage	With Bucket / Mug	In Running Tap / Pipe
Bathing	18 litres	100 litres
Flushing	6 litres	20 litres
Washing clothes	36 litres	116 litres
Shaving	½ litre	5 litres
Brushing teeth	¼ litre	5 litres
Washing car	10 litres	50 litres
Water plants	10 litres	50 litres
Watering garden	25 litres	100 litres

Please use bucket.. Notice the difference.....

### **Choice is Ours**

*Whether to enjoy and be safe with*

**Reliable** municipal supply / bore well water  
or

**Unreliable** water tankers

Save at least 300 litres of water per day  
with minor changes in life style..

**Please help save water ...**

**Help save our future ....**



**Contribute to an Eco Responsible Institute**